



Published by  
The Clay Brick Association  
of Southern Africa

Cnr Dick Kemp & Herman Road,  
Meadowdale, Edenvale, Gauteng

Editor: Dianne Volek

The Clay Brick Association represents the clay brick and paver manufacturers of Southern Africa. We research and advise our industry on energy-efficient, sustainable, inclusive production technologies. We inspire eco-friendly, contemporary brick architecture and educate South Africans on best practice in masonry construction and restoration.

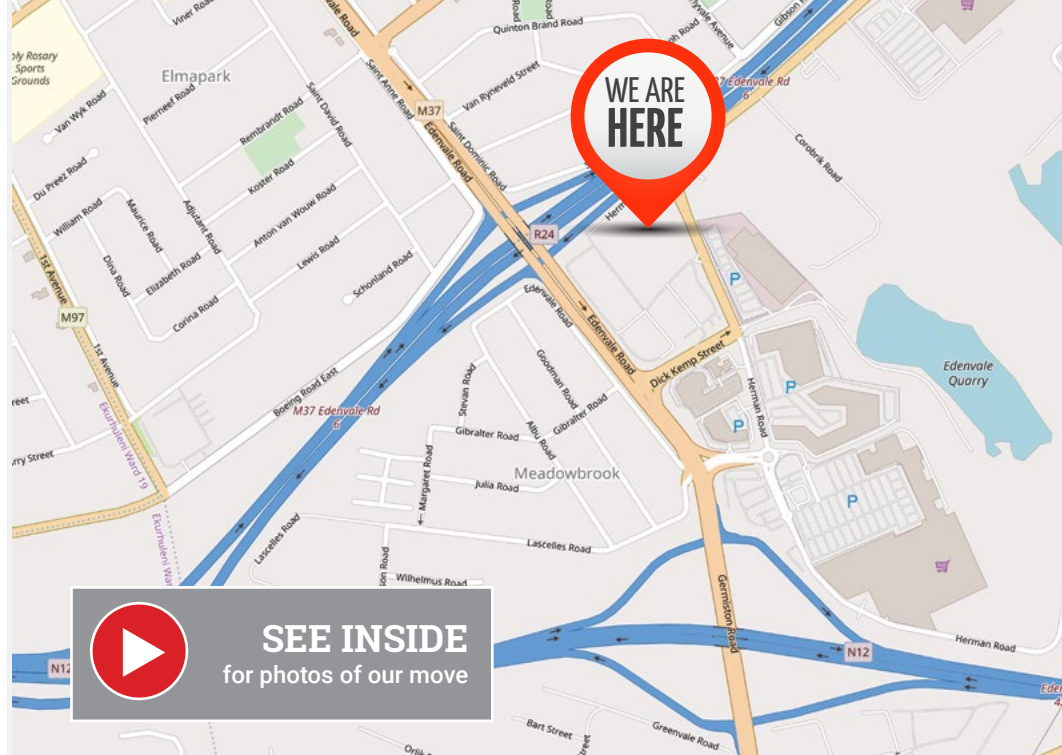

# THE VOICE

2019 - ISSUE 4

## OF THE CLAY BRICK INDUSTRY



### To our ClayBrick family...

As we approach the end of 2019, I want to thank each of you for being part of this family. I appreciate your hard work and dedication - your commitment has been integral to CBA's progress and success.

Surviving in a sector that is constantly challenged is an achievement to celebrate! After 56 years of serving the needs of members, the CBA are honoured to be here with you. And we are proud to have done it on the back of strong values and disciplined, scientific research; research that helps our members and raises our profile and credibility in the industry.

We are delighted to see more of our members engaging, learning and getting involved in CBA events and activities. We are supported by our committed Board of Directors who demonstrate their integrity and experience with every decision.

We have made significant progress with our Switch Africa Green project that is co-funded by the EU, promoting inclusive sustainable practice in the South African clay brick sector.

Thank you to all members contributing to benchmarking on the Portal. And I salute the courage of the pioneers shifting their operations towards a sustainable future.

Progress has been achieved against the backdrop of a difficult year that saw a competitive trading environment, a sluggish economy and the implementation of Carbon Tax. There is more to be done, and next year's calendar is filling up with CBA technical activities and marketing events that will lead to continued learning and successes.

The CBA offices have moved to Meadowdale, adjacent to the Corobrik regional office. The 9km journey from OR Tambo will be more convenient for our executives attending national meetings. It is also considerably closer for both me and Marnie so yes, lower CO<sub>2</sub> emissions!

As we approach year end, I wish you all a joyful festive season, and a new year that is filled with peace, success, happiness and good health. Be thankful for what you have, and for the good company of family and friends.

**Mariana Lamont**  
Executive Director





**TECHNOPOL SA**  
ENERGY SAVING MATERIALS

ENGINEERED LiteCel™ THERMAL INSULATION CORE MATERIALS FOR ALL APPLICATIONS



Floor Insulation  
Ceiling and Roof Insulation Systems  
Wall Insulation Options  
Insulated Façades and Plaster Systems  
Industrial Insulation for tanks, cold storage and piping



## Cavity Wall Insulation

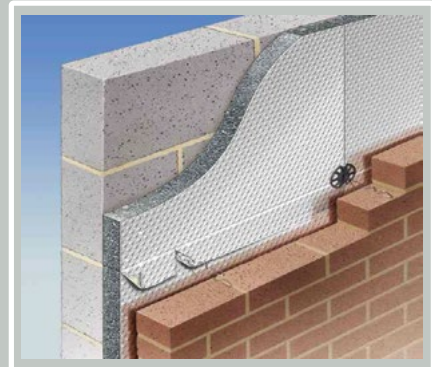
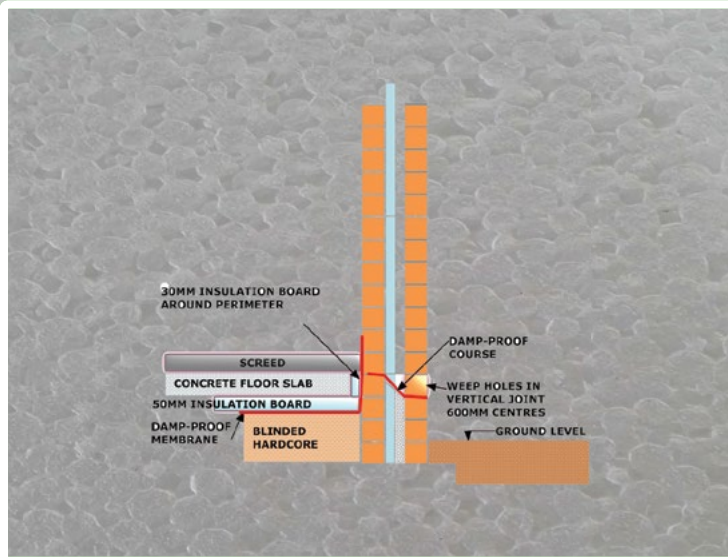

### FR Cel™ Thermal properties - @20g/l density

Thickness	50	100	150
Thermal resistance R(m2K/W)	1.43	2.85	4.29

## PolyKey Wall insulation

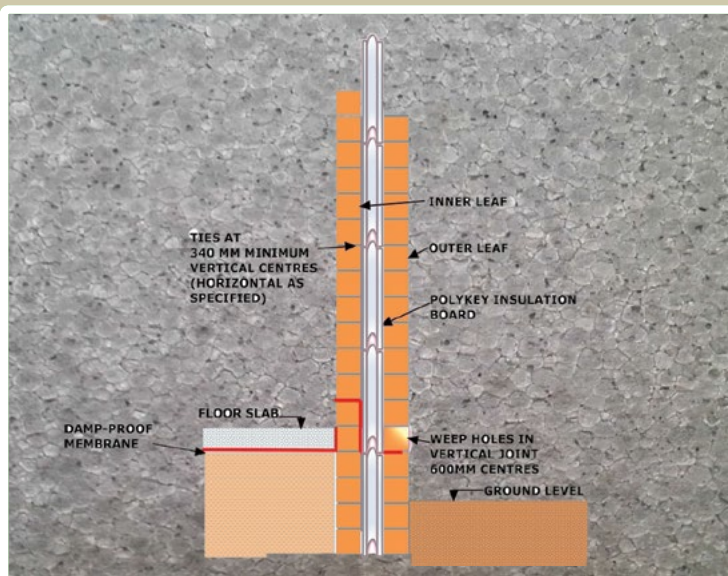

### GreyCel™ Thermal properties - @20g/l density

Thickness	50	100	150
Thermal resistance R(m2K/W)	1.60	3.20	4.84



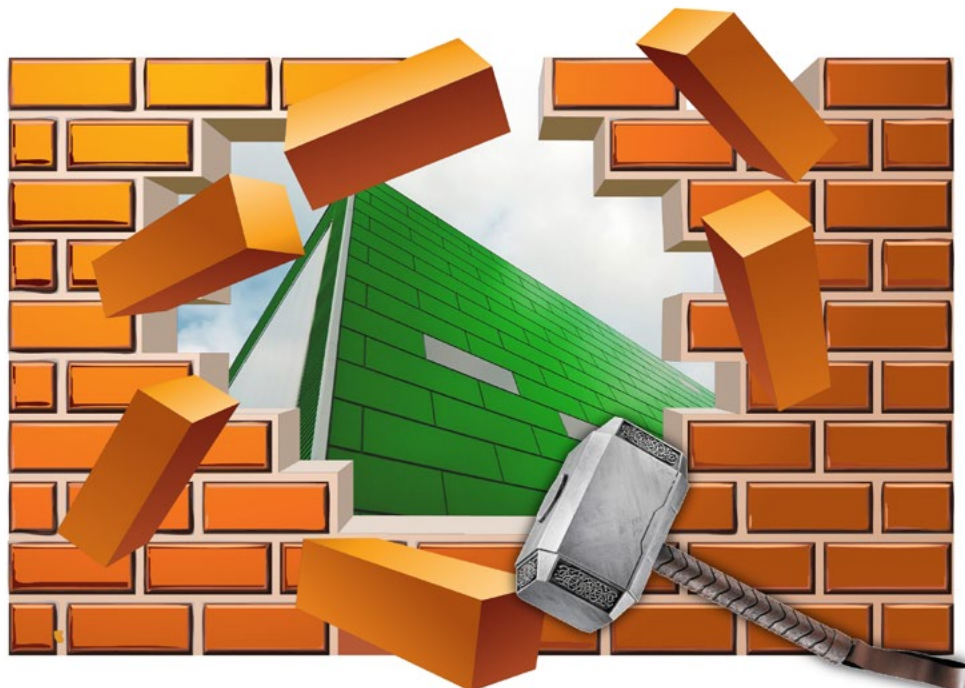

# Be the leader, be the change

By the end of the year, our days are packed to the brim with holidays, family celebrations and travel. While you take a break from day-to-day operations, take a step back to reflect. The year's end means the beginning of a new one with new possibilities. Be the leader, be the change. Start now to lay the groundwork for new perspectives in your business.

Demands for sustainable practices have transformed the competitive landscape. Pressure from both sides - consumers and government - is forcing companies to change the way they think about products, technologies, processes and business models.

In tough times, the human instinct is to cut costs, hunker down, stick with the familiar and try to wait it out. This can get you through a short dip, but in a real economic crisis these are the companies who shrink their way into quiet bankruptcy or a unprofitable takeover.

**The key to survival in an economic crisis is innovation.**

The companies who thrived after the bust in 2000 and at the end of the 2007-2010 recession were the ones who challenged the status quo.

1. Google made comparison shopping and finding information quicker.
2. Microsoft made business admin cheaper and easier.
3. Amazon allowed you to buy the next book in the series immediately.
4. In 2008 AirBnB reinvented the hospitality industry.
5. In 2009, Uber reimaged the taxi industry.

**All these innovative "game changers" hit the profitability the current major players overnight, because they took advantage of the "new reality" of thriftiness.**

Here in South Africa, Discovery Bank and Capitec are changing the nature of banking, although in different ways. They are leaving the other "too big to fail" South African banks scrambling for customers.

But these companies did not achieve success by innovating DURING the hard times, they did it by anticipating the future.

**Treat sustainability as a goal today! The early movers will develop competencies that rivals will be hard-pressed to match.**

That competitive advantage will stand them in good stead, because sustainability is not going away. In many countries it is already a requirement – single use plastic bags and cups are being banned almost overnight in European and Canadian cities. Car emissions get stricter, and electric cars are being launched by new players.

In our own industry, energy-efficiency specifications in housing are now universal and concrete manufacturers are experimenting with additives.

Did you know there is a concrete that traps CO<sub>2</sub> emissions forever, while providing extra strength that reduces the volume of cement needed! ([www.carboncure.com](http://www.carboncure.com)). Innovation is not only evolution, it is revolution! And it's already here!

**How is your company responding to changing legislation, changing customers and a changing construction landscape? Will YOU be the leader?**

CBA Executive Director Mariana Lamont shares this insightful leadership article from Harvard Business Review.

Go to the CBA website to read how you can plan your next steps for a fresh, sustainable approach in 2020!

## Stage 1:

Compliance is an opportunity.

## Stage 2:

Your entire value chain must be sustainable.

## Stage 3:

Identifying and designing sustainable products and ancillary services.

## Stage 4:

Developing new business models.

## Stage 5:

Going beyond "Best Practice" to "Next Practice".



**This issue of The Voice celebrates clay brick manufacturers that are challenging norms, embracing technology and going beyond minimum compliance in terms of sustainability!**



The Switch Africa Green Project is co-funded by the European Union



## Measure and manage your KPIs with the free Sustainability Portal

42 production facilities are registered on the web-based clay brick industry Sustainability Portal - a free and user-friendly tool to streamline data collection and operations sustainability over time, within a secure, confidential environment.

- Easy to understand Infographics and practical reports measure your sustainability trends and improvements against industry indicators.
- Accurately assess the ROI of sustainability investments for fuel or resource reduction.
- Calculate carbon tax and complete tax submissions to meet your company's legal obligations regarding DEA greenhouse gas reporting.

### Key Performance Indicators

- |  |                               |
|--|-------------------------------|
| 1a. Production emissions                   | 5b. Waste recycling           |
| 1b. Transport emissions                    | 6a. Clay resource efficiency  |
| 2a. Production energy efficiency           | 6b. Packaging material use    |
| 2b. Alternative production energy          | 7a. Biodiversity              |
| 3a. Dust fallout                           | 7b. Site Stewardship          |
| 3b. Air pollution during production        | 8a. Employee empowerment      |
| 4a. Water efficiency in production         | 8b. Diversity                 |
| 4b. Alternative water supply in production | 8c. Gender equality           |
| 5a. Production waste                       | 9a. Sustainability monitoring |
|  | 9b. Sustainability investment |

## Switch Africa Green Project Progress

The SWITCH Africa Green project – Promoting Inclusive Sustainable Practices in the South African Clay Brick Sector – was initiated by the CBA in 2018. This sustainability strategy will lead to cost-effective, fuel-efficient, resource-efficient production. It will also limit carbon tax liability and risk, while reducing damage to human health and the environment.

The project is co-funded by the European Union and executed jointly by Clay Brick Association of Southern Africa, EcoMetrix Africa (EMA) and Partners for Innovation.

### Informal clay brick sector education

The Clay Brick Association has produced a user-friendly A4 leaflet for distribution to small-scale and informal sector clay brick production facilities. The factsheet outlines practical opportunities for cost savings that will simultaneously result in greater efficiency and reduced environmental impact.

"It is anticipated that this introductory leaflet will open up discussions with small entrepreneurs who have not previously considered their impact on ecology," says John Volsteedt who heads up this section of the EU Switch Africa Green project.

"Most SMMEs assume that implementation of sustainable production will be expensive and unprofitable, or just too difficult. Through education they realise that even modest changes in how they operate have an impact on sustainability. Fast results are achievable and they benefit from continuous improvement."

Each topic in the brochure considers different opportunities:

- Opportunities for saving on energy and fuel
- Opportunity for saving water
- Opportunities for saving on raw materials
- Opportunities for reducing waste
- Opportunities for enhancing local biodiversity
- Opportunities for community social development

"With the continued drought, access to water has become a problem so brick-makers are open to ideas for reduced water use," explains John. "The cost of energy and lack of available land, as well as low prices due to poor quality are all reasons for them to participate enthusiastically in our education initiative."



Download the brochure on our website [www.claybrick.org!](http://www.claybrick.org!)

Informal brick-makers in Queenstown and Beaufort West



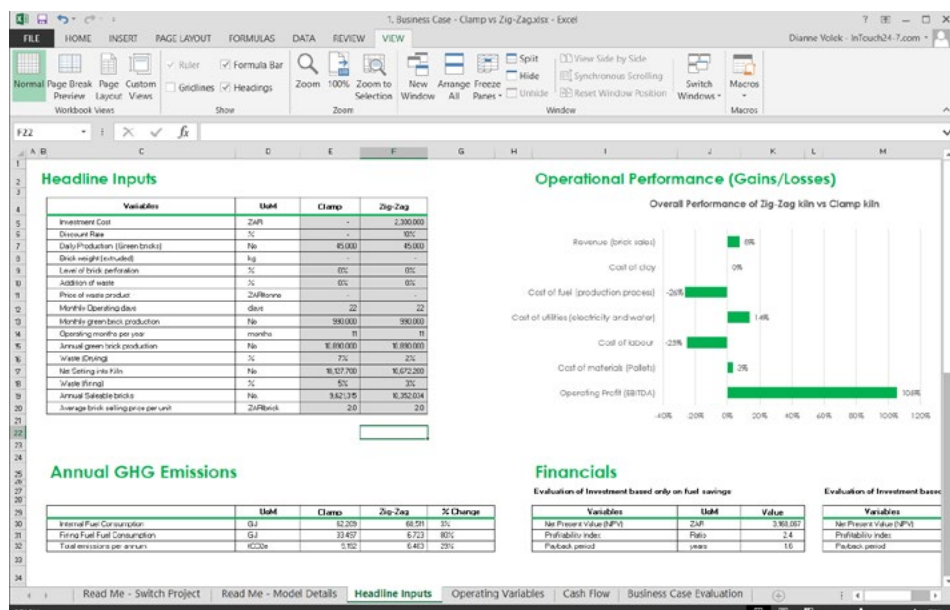

## EXCEL-BASED BUSINESS CASES

*Which sustainability initiatives will work best for your business? These spreadsheet-based interactive calculators could have the answer!*

Many CBA members know that being sustainable is good for their business, their community and the country as a whole. But when it comes to identifying the right sustainability projects for **their** business, there are so many options. Which projects are going to provide the best Return on Investment, with the shortest payback period?

To answer this important question, Switch Africa Green is developing a set of Excel-based business cases to assist clay brick manufacturers to evaluate the feasibility of implementing various sustainability measures or actions in their operations. This will offer brick makers a preliminary indication of project viability.

### Which initiatives are available?

The first three sustainable initiatives assessed are:

1. Switching from a clamp kiln to a more energy-efficient zig-zag kiln.
2. Producing perforated instead of solid brick products.
3. Waste symbiosis. Using or adding waste products as raw materials during the production process.

Each Excel-based business case model considers:

1. The rationale for the business case and the parameters used for financial modelling. Assumptions are based largely on existing literature (e.g. the Clay Brick LCA, EECB project-specific business cases and international business cases.)
2. Headline Inputs: capital investment required and specific operational variables. Default values can be edited.
3. Operating Variables: variable costs such as clay, fuel, electricity and water consumption as well as labour. Some default values can be edited.
4. Cash Flow: Annual operating income and expenditure (calculated).
5. Business Case Evaluation: savings achieved and expected additional revenue extrapolated over a 5-year period.

### Which feasibility factors are used?

The financial feasibility of the investment is evaluated in terms of the potential savings in operating costs over a 5-year period. These savings are then compared to the capital investment made and evaluated:

- **Net present value (NPV)**  
The difference of the initial investment and the value of the cash inflows over time considering a rate of return and the time value of money.
- **Profitability Index**  
The ratio of the present value of cash inflows to the initial investment.
- **Pay-back period**  
The time required to earn back the cost incurred.

## IN THE COMMUNITY



### Algoa Zwartkops clean-up

As part of their Mandela Day Centennial 67 hours of service, staff from Algoa Brick partnered with Zwartkops Conservancy and the Department of Water and Sanitation at a clean-up of the Motherwell Stormwater Canal.

"We are proud to have partnered and participated in this initiative to make a difference in the Zwartkops Estuary and commemorate Madiba," says Algoa MD Nico Mienie.

### Federale Stene brings colour to Petra's kids



For Mandela Day, Federale Stene assisted Petra Home-Based Care in Mhluzi, Middelburg. This worthy non-profit provides meals for the kids as well as a safe space to do their homework.

"Their facility is in dire need of improvement, and is an ongoing project for Federale," explains marketing executive Natasha Bird.

"We co-ordinated with other local companies to add some colour to the facility and we sponsored extra playground equipment as well as books, toys and food for the children. We are sponsoring clay bricks for the boundary wall," she concludes.

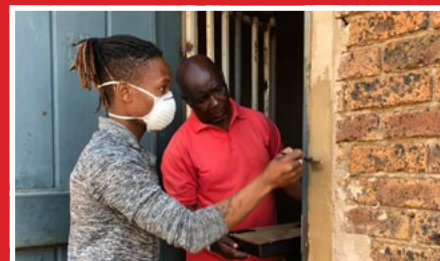

# Here comes the sun - Makana turns to solar power!

Makana Brick in the Eastern Cape has invested in a solar microgrid to supplement and secure their power supply. The farm of photovoltaic (PV) panels is designed to produce 600 000 kW hours per annum – 356kWp DC and 300kWp AC.

“The system will supply 17% of our electricity requirements,” reports Colin Meyer of Makana Brick. “It supplements grid power in operations including crushing and extrusion, as well as running all electrical motors for the fans and equipment on the dryer and kiln. As we run a night shift, this result exceeded expectations.

“With a capital cost of R4,5 million (financed through GBS Mutual Bank in Grahamstown) the payback period is less than 5 years. The first year savings are expected to be R675 000 before tax. With a 25 year lifespan, the savings can only increase.”

**“More importantly it has reduced our dependence on Eskom, minimising our exposure to arbitrary price increases.”**

The system is fully integrated with Makana’s substation, so there is no battery storage. Keeping panels dust free improves performance; although rain helps, Makana has installed a manual spray system to clean when necessary.

“The solution at Makana Brick is scalable,” advises Matt Ball of service provider Sinani Energy.

‘It could be expanded to produce all of the electricity required. With the installation of batteries to store excess energy, Makana Brick could go completely “off grid”.

## Tax implications

As of 1 January 2016 the South African government gave a tax incentive through the South African Revenue Service for the installation of photovoltaic solar energy generation systems. The accelerated depreciation depends on the size defined in MWp (Megawatt peak) of the photovoltaic solar system.

Photovoltaic solar systems smaller or equal to 1 MWp can be depreciated in one year. This offers a major cash flow benefit of 28% of capital expenditure in year one. Photovoltaic solar systems greater than 1 MWp are depreciated with the schedule 50%, 30%, and 20% in the first 3 years respectively.

The combination of the Section 12B tax benefit and the annual energy savings results in a simple payback of just over four years.

## Countering energy supply concerns

Eskom posted a R20-billion loss in 2019, continuing its downward spiral of operational and economic failure. Finding alternative energy sources is an urgent risk-management strategy. Many individuals and businesses counter energy security concerns by resorting to traditional solutions like petrol generators and fossil fuel sources like coal.

Even after discounting health and environmental concerns, these “fossil fuel” based solutions continue to incur ongoing costs in terms of procurement, logistics, storage, quality monitoring and carbon tax.

In comparison, solar energy is one of the cleanest energy solutions available – and is completely renewable. In fact, the sun continuously delivers around 1 366 watts of direct solar radiation per square metre or around 150 000 terawatts globally.

South Africa’s climate is ideally suited to solar leveraging free sunlight to generate electricity. Most areas in the country average more than 2500 hours of sunshine per year – one of the highest rates in the world thanks to its equatorial location.

**Solar provides an attractive internal rate of return (IRR) as solar electricity is free after the initial payback period.**

Solar technology is continually evolving and innovating, and this power source is disrupting conventional thinking with respect to energy planning. Because solar projects are within the budget and capabilities of the private sector, they can bring much-needed power alternatives especially in underdeveloped, rural or remote areas.

For Makana, solar solution was an obvious choice in order to...

**...take control of energy costs.** Going forward, Makana Brick will only be exposed to Eskom tariff increases on the portion of the electricity that they buy from Eskom. The electricity produced by their solar system will be fixed, based on the capital that they have invested.

**...convert to renewable, green energy.** This is not only good for the environment, but can be used to offset carbon tax.



The fixed-tilt, ground-mounted solar panels are angled at 25 degrees relative to the ground, and face northwards towards the midday sun.



The system was installed by CBA Associate Member Sinani Energy, a level 2 B-BBEE company specialising in solar photovoltaic systems and energy smart metering.





## Sinani Energy

Sinani Energy is an energy solutions provider delivering tailored products and services to optimise energy efficiency, reduce carbon emissions and lower reliance on the national grid – ultimately improving business profitability and sustainability.

“We follow a multi-phase design process,” says Matt Ball.

“In the Makana installation, only the highest quality equipment was used:

- Solar Modules are Tier 1 which is the highest quality and only bankable tier of solar modules. We used Canadian Solar modules for this project
- SMA inverters are manufactured in Germany. SMA is one of the leading global specialists in Solar PV System technology
- Mounting structure was supplied by Schletter and is made of aluminium and galvanised steel.

Established in 2015, Sinani is a level 2 B-BBEE company specialising in:

- Solar photovoltaic systems
- Energy consulting & advisory
- Smart metering and monitoring
- Backup solutions including UPS systems and generators.

## BENEFITS OF SOLAR POWER

### 1 RENEWABLE ENERGY

Solar energy is a renewable power source, it cannot be depleted.

### 2 ABUNDANT

The earth receives around 150,000 terawatts of solar radiation free, continuously – about 20,000 times more energy than the world uses.

### 3 SUSTAINABLE

Sustainable energy sources fulfil the needs of the present day without the need of compromising the power of generations to come to meet their requirements.

### 4 GOOD FOR THE ENVIRONMENT

Harnessing power from the sun does generally not pollute the environment. The emissions involved with the production, transportation and installation of solar power systems are practically nothing in comparison to most common energy sources.

### 5 GREAT AVAILABILITY

Solar energy can be acquired anywhere in the world although it is easiest in countries close to the Equator like South Africa.

### 6 MINIMIZES ELECTRICITY COSTS

Businesses reduce their total electricity expenses. In time, it is hoped that South Africa will allow users to sell excess electricity back to Eskom.

### 7 RELIABLE

Solar energy produces electricity in regions that don't have a reliable grid connection or supply.

### 8 SILENT

With no moving parts, solar power is usually silent and does not disturb animals or local communities.

### 9 FINANCIAL ASSISTANCE

Public sector tax rebates and incentives are available for some businesses and homeowners. The growing popularity of solar is reducing capital costs and encouraging innovation in both design and production.

### 10 LOW MAINTENANCE

Solar power systems require annual maintenance inspections and often only need cleaning a few times each year, depending on rainfall.

[www.sinanienergy.com](http://www.sinanienergy.com)

See the CBA website for contact details

A Sustainability Factsheet is being prepared on the Makana Business Case. For technologies and practices that reduce fossil use, go to [www.claybrick.org](http://www.claybrick.org)

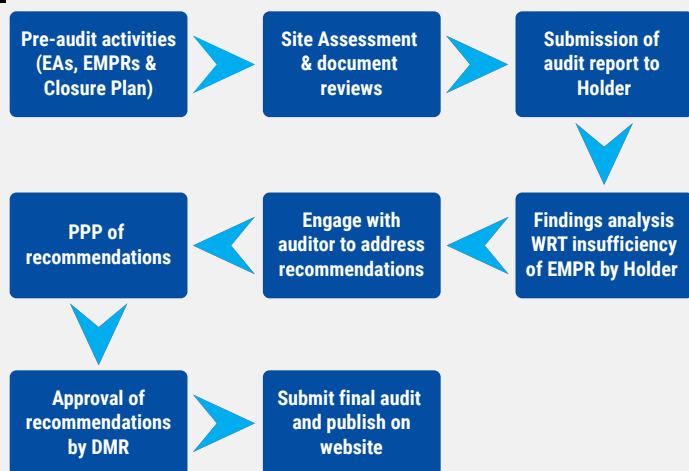

## REGULATION 34 DEADLINE: 7 DEC 2019

### Environmental auditing

Under Regulation 34, holders of Environmental Authorisations (EAs) must ensure that the EA and Environmental Management Program (EMPR)/closure plan is audited and that an environmental audit report is submitted to the competent authority by no later than **7 December 2019**.

Regulation 34 requires the following to be audited:

- EAs granted in terms of the ECA or EIA Regulations (2006, 2010 or 2014) and associated EMPRs
- EMPRs approved in terms of the MPRDA prior to 8 December 2014
- EMPRs submitted in terms of the MPRDA prior to 8 December 2014 but approved after 8 December 2014
- EMPRs approved in terms of NEMA after 8 December 2014
- Where relevant, the Closure Plan must undergo the same process described for EMPRs. Regulation 34 of the EIA Regulations of 2014 does not apply to all Closure Plans.

Licences not explicitly included in Regulation 34 are:

- Water Use Licences
- Waste Management Licences
- Atmospheric Emission Licences

For assistance with Regulation 34 audits, contact ENVASS See the CBA website for contact details.



FEDERALE STENE delivered 5 000 stock clay bricks – the first of a 20 000 sponsorship consignment – to the Recreational Hub for Nasaret Against Drugs and Alcohol (NADA).

The NADA Recreational Hub is aimed at providing a space for kids in Nasaret, Middelburg to hang out and interact with one another in a positive way. These bricks will be used in the foundation and low boundary walls around a netball field, soccer field and outdoor chess board.

NADA aims to keep the kids in the area off drugs & instead focus their energy on sports and healthy alternatives for their time.



Gunther Gruen and David Matlou of Nova Brick, opening the new media Centre with the principal and teachers of Balebogeng Primary school in Mamelodi East.

### Nova supports Balebogeng Primary

“The need for a media centre at Balebogeng Primary School near our offices, was brought to our attention by an former pupil,” reports Nova Marketing Director Gunther Gruen.

**“We immediately saw that the new media centre and science room was an investment in the next generation.”**

Nova Brick and the school principal presented an initial plan for the infrastructure to the DMR and representatives of the City of Tshwane at the end of the 2016 school year. The project was finally approved by the DMR in late 2017 after meetings with parents, funders and the Education Department. The school struggled for over a year to raise further funding, until Nova generously agreed to provide additional financial support.

The project went to tender in early 2019 and a local contractor, Mohlamonyane Business Construction, was appointed. “We supported job creation in the area by employing only local suppliers, tradesmen and labourers,” confirms Director Samuel Mohlamonyane, who is an ex-pupil of Balobogeng primary.

The construction team quickly sped into action.

“Ground breaking started in June 2019,” concludes Gunther. “It is with great pride that we can report our project at Balebogeng Primary School was successfully completed in just a few months, with the official hand-over taking place in November 2019.”



Does your company have community and social involvement stories to share? Email [web@claybrick.org](mailto:web@claybrick.org)





The Clay Brick Association was proud to be the main sponsor for a month-long series of **WOMAN IN ARCHITECTURE** events at the Cape Institute for Architecture. This sponsorship built on our growing relationship with the institute and local architects.

"I would like to thank you for your most generous support of our WIA series of events" responded ClfA President Nicola Irving. "It not only shows the CBA is supporting change in the building industry but acknowledges the contribution the female architects make to the broader profession."



80 professionals attended the curated exhibition and a set of CPD accredited talks drawing on the work of women in practice. CBA representatives had an opportunity to network with the architects, and to strengthen ties with these professionals who educate clients on sustainable building, and go on to specify clay masonry at the design stage of infrastructure projects.

As the largest and oldest Institute in South Africa, ClfA is an important partner for the CBA, with 900 ClfA members in the Western Cape and 2300 SAIA members nationwide.

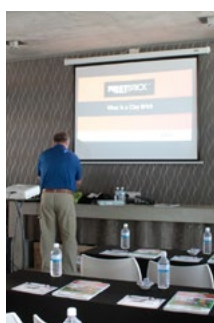

## CBA EDUCATION EVENTS

Over the past few months, The Clay Brick Association has organised and sponsored education events for both members and construction professionals in the Eastern and Western Cape, Gauteng and Limpopo. All were well attended and we thank members for their participation. In November, Dr Andrew Smith of Derby University presented a 2-day course on "Properties of clays", covering Drying and Firing processes.



*Seen at the Eastern Cape regional lunch*

## AGM 2020

The 57th AGM will be hosted by the Eastern Cape region from 14 to 17 May 2020.

Umngazi River Bungalows & Spa is an appropriate venue to expand on our sustainability theme of **Today's Footprint, Tomorrow's Legacy**, focusing on water and ocean conservation.



## CBA Members show off the benefits of clay pavers



The Clay Brick Association showed off the benefits and beauty of South African clay pavers and bricks at FutureScape Africa in October. FutureScape is the leading event in exterior design, landscaping, paving and maintenance. By exhibiting at the show, the CBA communicates with the entire industry through one event.

627 delegates attended a full day of seminars hosted by influential industry leaders representing municipal, commercial and residential outdoor built environments. Between lectures the delegates visited exhibition stands in the main hall. Thank you to John Volsteedt of the CBA, Cabrico and Corobrik for manning the stand!



## Congratulations Worcester Brick!

The Clay Brick Association of Southern Africa extends our warmest congratulations to the Marais family and their team at Worcester Brick, as they celebrate 75 years of business success!

It is a privilege to work with a company that is so deeply committed to quality, sustainability and community support.

Worcester Bricks celebrated its 75th anniversary in August 2019 with Nico and Simoné Marais as the third generation of brick makers.

The company's bricks can be seen in just about every building in Worcester - from Mediclinic to The Court.

"The staff plays a key role in the growth and development of the company and we are very grateful for their contribution," says Nico Marais, managing director of Worcester Brick.

Marais says the past 75 years serve as the foundation for the future. Many more years of hard work lie ahead to continue to succeed and build on the legacy of grandfather, Hennie Marais Sr.



## Corobrik sponsors Tembisa school

Left to Right: Lerato Mokgotsi (Corobrik), Julia Hlahle (School Principal) and Ephraim Tau (Chief Director GP Department of Education) with two of the schoolchildren.



Moriting Primary School in Tembisa lies between Corobrik's Midrand factory and Corobrik's Rietvlei factory.

As a high-performing primary school, Moriting works to accommodate a growing number of pupils. This has put severe strain on the existing facilities resulting in an average of 41 children per classroom. Therefore the additional five new Corobrik classrooms have been welcomed by staff, parents and pupils as smaller class numbers can now be accommodated.

The children of Corobrik staff members working at both factories and residing in Tembisa will also benefit, as many of their children attend Moriting Primary School.

Read the full story on [www.claybrick.org](http://www.claybrick.org)

## Interpreting the 2018 Mining Charter

### Mining Charter

*Fundiswa Ndaba, Senior Policy Analyst: Public Affairs and Transformation at The Minerals Council reports on the Mining Charter 2018*



MC2018 became effective on the 1 March 2019. Mining right holders must report on the new Charter by 31 March 2020.

### KEY POINTS

- MC2018 is more balanced and an improvement on the Mining Charter of 2017.
- Local content targets are unrealistic and state incentives are needed for effective implementation.
- The lenient exemptions for new mining right applications for Junior and Emerging miners do not apply equally to existing mining right holders.
- Clarification is required on some provisions.

"MC2018 is a balanced and better Charter compared to Mining Charter 2017, however it also has its challenges which have been included in the Review Application of the Mining Charter.

"Major concerns include the limited application and recognition of continuing consequences of historical transactions on Renewal and Transfer Applications and the provisions and targets for local content under the Inclusive Procurement element.

"The industry fully supports local content and local manufacturing, as this would have a positive impact on job creation, however the local content targets set in MC2018 are unrealistic and will take decades to achieve. They will also require state incentives and programmes to ensure effective and progressive industrial development.

"MC2018 introduced more lenient provisions (exemptions) for new mining right applications for Junior and Emerging miners. This is a positive for the Junior mining sector. However, it doesn't assist existing mining right holders that are "Junior and Emerging miners" by definition, as they would still have to comply with the MC2018 provisions that apply to all right holders. A positive for Prospecting right holders is the removal of MC2018 provisions.

"MC2018 required the mining right holders to submit their Employment Equity and Inclusive Procurement Plans to the Department of Mineral Resources and Energy (DMRE). 2019 is the first year of implementation of MC2018 and there are still a few challenges with clarity on some of the provisions. The industry would appreciate direction and further consultations with the DMRE on implementation of MC2018.

"The Mining industry supports the Mining Charter as a policy document for Socio-Economic Transformation of the industry and is fully committed to growth and competitiveness."

Visit the CBA website to download Deloitte's Commentary and insights on the draft 2018 Charter



## Corobrik makes investment pledge of R1 billion

Corobrik is one of several local businesses who has taken heed of President Cyril Ramaphosa's call for investment.

Speaking at the 2nd South African Investment Conference in November, chief executive, Dirk Meyer, told the high profile private and public sector gathering that the company had invested R550 million in its new Driefontein plant to date and would inject a further R250 million into the project during 2020.

The Driefontein factory will generate at least 20% of its electricity needs from renewable resources. Natural gas consumption for the kilns would be reduced by more than 60% and the carbon footprints of both kilns would be substantially reduced.

An additional R200 million is being invested in a new manufacturing facility to the north of Durban.

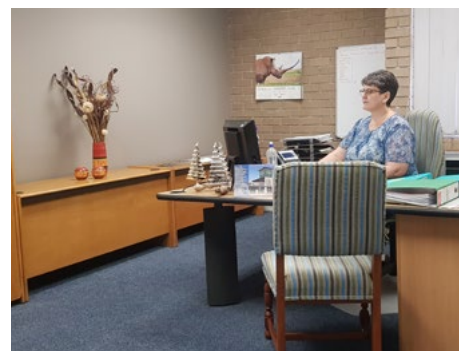

*The relocation from the old Irene offices proceeded the speed and efficiency we have come to expect of the CBA team! Within 48 hours they were up-and-running at the new offices conveniently located adjacent to Corobrik's regional office in Meadowdale.*



## Year-end shutdown

The CBA offices will close on Friday 13 December 2019 and reopen on Monday 6 January 2020.

## MEMBER PROJECT: FUTURE AFRICA

In a tranquil setting in the heart of Pretoria, a new hub of scientific discovery and innovation for Africa is taking shape. Located on the northern ridge of Strubenskop with panoramic views of Pretoria, the campus anchors the southern edge of the University's experimental farm, Proefplaas.

*According to deputy vice-chancellor for research, Professor Stephanie Burton, the Future Africa campus will bring together global researchers, scientists and partners from many disciplines to work on research projects that could resolve some of Africa's biggest socio-economic problems.*

The architect's brief required multiple facilities to be integrated into the campus, including a dining hall, a conference centre, research commons plus 300 living units ranging from single bedrooms to family units.

"The Research Commons focuses specifically on interconnectedness of space and knowledge flowing between informal discussion pits, meeting rooms, and study tables," describes Burton.

Defined by a brick envelope exterior, the timber interior of the Research commons establishes more informal shared areas with natural materials and textures. Clay bricks were supplied by Nova Brick.

A further requirement was to keep expansion in mind from the beginning.

Clay brick is the ideal construction material for the family and student accommodation due to its thermal comfort and energy efficiency. This will allow the building envelope to moderate hot summer days and cold highveld nights without the need for expensive heating or air-conditioning.

The calming, natural tones and textures of clay brick and timber are balanced by panels of vibrant red, yellow and blue.

See more photos on [www.claybrick.org](http://www.claybrick.org)







**Direxa**  
ENGINEERING

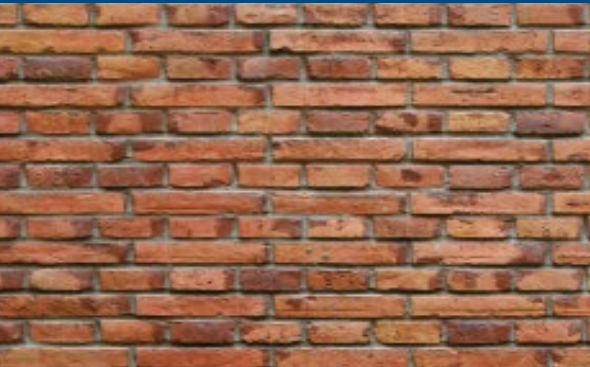

## Solution Provider

Direxa holds the view that the only way to a bright future for the Brick Industry in most countries, is through innovation. This means new appropriate innovative technology, tailored to the reality of each market.

With a dynamic team of engineers, we are well equipped and experienced to design, build, and retrofit plants for the Clay Product Industry and other Ceramic Industries.

We are able to customize and tackle any large or small project in the Clay Product Industry. Our job is to find the specific answer to the specific need of the customer. Contact us to discuss your next project today.

**Designer and builder of complete plants for the  
Ceramic Industry**

**Direxa**  
ENGINEERING

Represented in South Africa by:



14 Kya Sand Rd, Kya Sand, Randburg, 2163, South Africa  
Contact: Andrew Dunn | +27 11 462 2226

3609 S. Wadsworth Blvd., Suite 370, Lakewood, Colorado 80235

[www.direxa.com](http://www.direxa.com) | [info@direxa.com](mailto:info@direxa.com) | (1) 720 263 5685



Denver

Sao Paulo

Melbourne

Johannesburg